



Écrous à sertir en aveugle Blind Rivet Nuts

Material : Steel

Matière : Acier

Head : Flush

Tête : Affleurante

Body : Round

Fût : Cylindrique



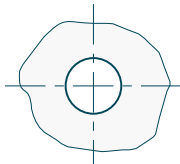
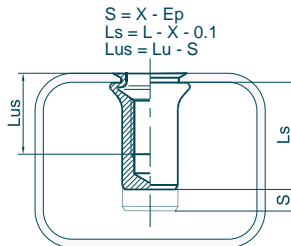
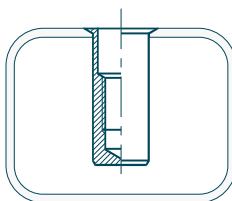
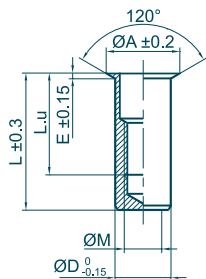

Body end : Closed End

Extrémité du fût : Borgne

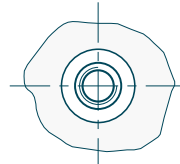

Outillages de pose
Fastening tools
se référer à / refer to
TOOLIN'FIX



Ø M	Ep		Code	mm ØT	Ø A	L	L.u	E	Ø D	X indicative data				
	min	max												
M2.5 x 0.45	0.0 - 1.1		01A025ARB011Z	4.0	4.6	9.7	5.6	0.3	4.0	2.4	300	1.0	0.8	0.5
	0.8 - 1.7		01A025ARB017Z	4.0	4.6	10.3	6.5	0.3	4.0	3.0	300	1.0	0.8	0.6
M3 x 0.50	0.0 - 1.1		01A030ARB011Z	5.0	5.8	11.9	6.7	0.3	5.0	2.4	450	1.4	1.0	1.1
	1.0 - 2.3		01A030ARB023Z	5.0	5.8	13.1	8.2	0.3	5.0	3.6	450	1.4	1.0	1.1
	2.1 - 3.2		01A030ARB032Z	5.0	5.8	13.8	8.7	0.3	5.0	4.7	450	1.4	1.0	1.2
	3.0 - 4.1		01A030ARB041Z	5.0	5.8	14.7	9.6	0.3	5.0	5.6	450	1.4	1.0	1.2
M4 x 0.70	0.0 - 1.3		01A040ARB013Z	6.0	6.8	15.1	8.5	0.3	6.0	2.6	750	3.2	2.1	1.9
	0.5 - 3.0		01A040ARB030Z	6.0	6.8	16.7	10.1	0.3	6.0	4.3	750	3.2	2.1	2.0
	1.8 - 4.2		01A040ARB042Z	6.0	6.8	18.0	11.4	0.3	6.0	5.5	750	3.2	2.1	2.1
	3.5 - 5.5		01A040ARB055Z	6.0	6.8	19.5	12.9	0.3	6.0	6.8	750	3.2	2.1	2.2
M5 x 0.80	0.0 - 1.5		01A050ARB015Z	7.0	8.0	16.8	10.5	0.4	7.0	3.0	1050	6.4	3.2	2.7
	0.0 - 2.5		01A050ARB025Z	7.0	8.0	17.8	11.5	0.4	7.0	4.0	1050	6.4	3.2	2.8
	0.5 - 3.5		01A050ARB035Z	7.0	8.0	19.3	13.0	0.4	7.0	5.0	1050	6.4	3.2	3.0
	1.5 - 4.5		01A050ARB045Z	7.0	8.0	20.3	14.0	0.4	7.0	6.0	1050	6.4	3.2	3.1
M6 x 1.00	0.0 - 1.5		01A060ARB015Z	9.0	10.0	21.3	12.5	0.4	9.0	3.4	1800	11.1	6.0	6.3
	1.0 - 3.5		01A060ARB035Z	9.0	10.0	23.3	14.5	0.4	9.0	5.4	1800	11.1	6.0	6.6
	2.0 - 4.5		01A060ARB045Z	9.0	10.0	24.3	15.5	0.4	9.0	6.4	1800	11.1	6.0	6.7
	3.0 - 5.5		01A060ARB055Z	9.0	10.0	25.3	16.5	0.4	9.0	7.4	1800	11.1	6.0	6.9
M8 x 1.25	4.0 - 6.5		01A060ARB065Z	9.0	10.0	26.3	17.5	0.4	9.0	8.4	1800	11.1	6.0	7.0
	0.0 - 1.8		01A080ARB018Z	11.0	12.0	24.2	13.7	0.4	11.0	3.7	2950	27	10.5	9.8
	0.0 - 3.0		01A080ARB030Z	11.0	12.0	25.4	14.9	0.4	11.0	4.9	2950	27	10.5	10.0
	1.3 - 4.2		01A080ARB042Z	11.0	12.0	26.7	16.2	0.4	11.0	6.2	2950	27	10.5	10.3
M10 x 1.50	2.0 - 5.0		01A080ARB050Z	11.0	12.0	27.5	16.8	0.4	11.0	6.9	2950	27	10.5	10.7
	3.5 - 6.5		01A080ARB065Z	11.0	12.0	28.5	18.0	0.4	11.0	8.4	2950	27	10.5	10.8
	0.0 - 3.2		01A100ARB032Z	13.0	14.5	31.9	21.4	0.6	13.0	6.0	4000	53	16.4	16.3
	2.0 - 5.5		01A100ARB055Z	13.0	14.5	34.4	23.0	0.6	13.0	8.3	4000	53	16.4	17.1
M12 x 1.75	3.0 - 6.5		01A100ARB065Z	13.0	14.5	35.4	24.0	0.6	13.0	9.3	4000	53	16.4	17.4
	4.5 - 7.5		01A100ARB075Z	13.0	14.5	36.4	25.0	0.6	13.0	10.3	4000	53	16.4	17.7
	0.0 - 4.2		01A120ARB042Z	16.0	17.5	36.3	23.7	0.6	16.0	7.3	6100	92	23.5	28.5
	2.0 - 6.0		01A120ARB060Z	16.0	17.5	38.2	25.6	0.6	16.0	9.1	6100	92	23.5	29.2
M14 x 2.00	3.5 - 7.6		01A120ARB076Z	16.0	17.5	39.7	27.0	0.6	16.0	10.7	6100	92	23.5	30.0
	6.0 - 9.2		01A120ARB092Z	16.0	17.5	41.3	28.5	0.6	16.0	12.3	6100	92	23.5	30.7
	0.0 - 3.0		01A140ARB030Z	18.0	19.5	41.6	27.6	0.6	18.0	7.0	7200	148	31.5	40.8
	1.0 - 5.0		01A140ARB050Z	18.0	19.5	43.6	29.6	0.6	18.0	9.0	7200	148	31.5	42.0
M16 x 2.00	3.0 - 7.0		01A140ARB070Z	18.0	19.5	45.6	31.6	0.6	18.0	11.0	7200	148	31.5	43.3
	6.0 - 9.0		01A140ARB090Z	18.0	19.5	47.6	33.6	0.6	18.0	13.0	7200	148	31.5	44.6
	0.0 - 3.2		01A160ARB032Z	21.0	22.5	44.1	27.2	0.6	21.0	8.2	10000	232	41	58.7
	0.0 - 5.7		01A160ARB057Z	21.0	22.5	46.5	29.6	0.6	21.0	10.7	10000	232	41	60.6
M16 x 2.00	2.0 - 8.2		01A160ARB082Z	21.0	22.5	48.9	32.0	0.6	21.0	13.2	10000	232	41	62.5
	6.0 - 11.0		01A160ARB110Z	21.0	22.5	51.9	34.7	0.6	21.0	16.0	10000	232	41	64.6

Écrou à sertir en aveugle correspondant à l'ancienne désignation M ... FB ... ACIER
Blind Rivet Nuts corresponding to old designation M ... FB ... STEEL