



Écrous à sertir en aveugle Blind Rivet Nuts



Matière : Aluminium

Material : Aluminium

Tête : Affleurante

Head : Flush

Fût : Hexagonal

Body : Hexagonal

Extrémité du fût : Ouvert

Body end : Open Shape

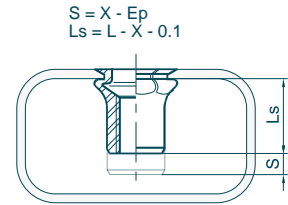
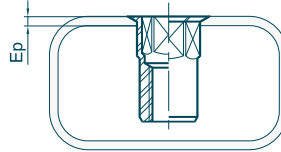
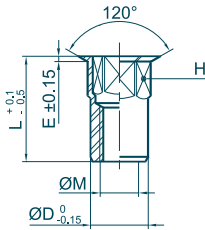

$$S = X - Ep$$

$$Ls = L - X - 0.1$$

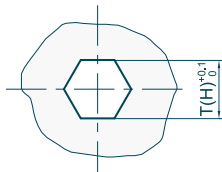

Outillages de pose
Fastening tools
se référer à / refer to
TOOLIN'FIX

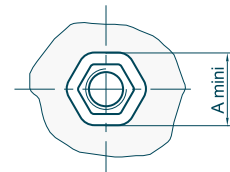

Ø M	Ep		Code	H	mm		A	L	E	Ø D	X	indicative data	daN	N,m	N,m	kg x1000
	min	max			T(H)	A										
M2.5 x 0.45	0.0 - 1.1	1.1 - 1.7	01U025AHO011X	4.0	4.0	4.6	6.4	0.3	4.0	2.4	165	0.6	0.6	0.1		
			01U025AHO017X	4.0	4.0	4.6	7.0	0.3	4.0	3.0	165	0.6	0.6	0.1		
M3 x 0.50	0.0 - 1.1		01U030AHO011X	5.0	5.0	5.8	7.2	0.3	5.0	2.4	225	0.8	0.8	0.2		
	1.0 - 2.3		01U030AHO023X	5.0	5.0	5.8	8.6	0.3	5.0	3.6	225	0.8	0.8	0.2		
	2.1 - 3.2		01U030AHO032X	5.0	5.0	5.8	9.7	0.3	5.0	4.7	225	0.8	0.8	0.2		
	3.0 - 4.1		01U030AHO041X	5.0	5.0	5.8	10.6	0.3	5.0	5.6	225	0.8	0.8	0.2		
M4 x 0.70	0.0 - 1.3		01U040AHO013X	6.0	6.0	6.8	9.4	0.3	6.0	2.6	400	1.9	1.8	0.3		
	1.0 - 3.0		01U040AHO030X	6.0	6.0	6.8	11.1	0.3	6.0	4.3	400	1.9	1.8	0.4		
	2.2 - 4.2		01U040AHO042X	6.0	6.0	6.8	12.3	0.3	6.0	5.5	400	1.9	1.8	0.4		
	3.0 - 5.5		01U040AHO055X	6.0	6.0	6.8	13.5	0.3	6.0	6.8	400	1.9	1.8	0.4		
M5 x 0.80	0.0 - 1.5		01U050AHO015X	7.0	7.0	8.0	10.8	0.4	7.0	3.0	650	3.8	3.7	0.5		
	0.5 - 2.5		01U050AHO025X	7.0	7.0	8.0	11.8	0.4	7.0	4.0	650	3.8	3.7	0.5		
	1.5 - 3.5		01U050AHO035X	7.0	7.0	8.0	12.8	0.4	7.0	5.0	650	3.8	3.7	0.6		
	2.5 - 4.5		01U050AHO045X	7.0	7.0	8.0	13.8	0.4	7.0	6.0	650	3.8	3.7	0.6		
M6 x 1.00	0.0 - 1.5		01U060AHO015X	9.0	9.0	10.0	13.3	0.4	9.0	3.4	1100	6.7	6.4	1.2		
	1.5 - 3.5		01U060AHO035X	9.0	9.0	10.0	15.3	0.4	9.0	5.4	1100	6.7	6.4	1.3		
	2.5 - 4.5		01U060AHO045X	9.0	9.0	10.0	16.3	0.4	9.0	6.4	1100	6.7	6.4	1.3		
	3.5 - 5.5		01U060AHO055X	9.0	9.0	10.0	17.3	0.4	9.0	7.4	1100	6.7	6.4	1.4		
M8 x 1.25	4.5 - 6.5		01U060AHO065X	9.0	9.0	10.0	18.3	0.4	9.0	8.4	1100	6.7	6.4	1.4		
	0.0 - 1.8		01U080AHO018X	11.0	11.0	12.0	14.7	0.4	11.0	3.7	1750	16.2	15.5	1.7		
	1.0 - 3.0		01U080AHO030X	11.0	11.0	12.0	15.9	0.4	11.0	4.9	1750	16.2	15.5	1.8		
	2.3 - 4.2		01U080AHO042X	11.0	11.0	12.0	17.2	0.4	11.0	6.2	1750	16.2	15.5	1.9		
M10 x 1.50	3.0 - 5.0		01U080AHO050X	11.0	11.0	12.0	17.8	0.4	11.0	6.9	1750	16.2	15.5	1.9		
	4.5 - 6.5		01U080AHO065X	11.0	11.0	12.0	19.3	0.4	11.0	8.4	1750	16.2	15.5	2.0		
	0.0 - 3.2		01U100AHO032X	13.0	13.0	14.5	20.6	0.6	13.0	6.0	2200	32	30.4	3.0		
	2.0 - 5.5		01U100AHO055X	13.0	13.0	14.5	22.9	0.6	13.0	8.3	2200	32	30.4	3.2		
M12 x 1.75	3.0 - 6.5		01U100AHO065X	13.0	13.0	14.5	23.9	0.6	13.0	9.3	2200	32	30.4	3.3		
	4.5 - 7.5		01U100AHO075X	13.0	13.0	14.5	24.9	0.6	13.0	10.3	2200	32	30.4	3.4		
	0.0 - 4.2		01U120AHO042X	16.0	16.0	17.5	24.3	0.6	16.0	7.3	3000	55	53	5.4		
	2.0 - 6.0		01U120AHO060X	16.0	16.0	17.5	26.1	0.6	16.0	9.1	3000	55	53	5.7		
M14 x 2.00	3.5 - 7.6		01U120AHO076X	16.0	16.0	17.5	27.7	0.6	16.0	10.7	3000	55	53	5.9		
	6.0 - 9.2		01U120AHO092X	16.0	16.0	17.5	29.2	0.6	16.0	12.3	3000	55	53	6.1		
	0.0 - 3.0		01U140AHO030X	18.0	18.0	19.5	26.6	0.6	18.0	7.0	3600	89	85	7.5		
	1.0 - 5.0		01U140AHO050X	18.0	18.0	19.5	28.6	0.6	18.0	9.0	3600	89	85	8.0		
M16 x 2.00	3.0 - 7.0		01U140AHO070X	18.0	18.0	19.5	30.6	0.6	18.0	11.0	3600	89	85	8.4		
	6.0 - 9.0		01U140AHO090X	18.0	18.0	19.5	32.6	0.6	18.0	13.0	3600	89	85	8.8		
	0.0 - 3.2		01U160AHO032X	21.0	21.0	22.5	28.0	0.6	21.0	8.2	5900	139	133	10.6		
	0.0 - 5.7		01U160AHO057X	21.0	21.0	22.5	30.5	0.6	21.0	10.7	5900	139	133	11.2		
	2.0 - 8.2		01U160AHO082X	21.0	21.0	22.5	32.9	0.6	21.0	13.2	5900	139	133	11.9		
	6.0 - 11.0		01U160AHO110X	21.0	21.0	22.5	35.7	0.6	21.0	16.0	5900	139	133	12.6		

Écrou à sertir en aveugle correspondant à l'ancienne désignation H ... fO ... ALUMINIUM
Blind Rivet Nuts corresponding to old designation H ... fO ... ALUMINIUM

