

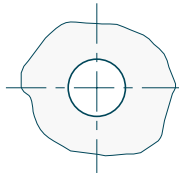

## Écrous à sertir en aveugle Blind Rivet Nuts

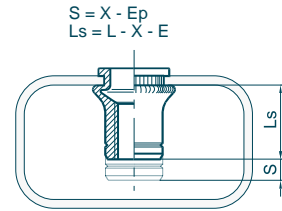

Matière : Inox 316L      Material : 316L Stainless Steel  
Tête : Cylindrique      Head : Flange  
Fût : Cannelé      Body : Knurled  
Extrémité du fût : Ouvert      Body end : Open Shape

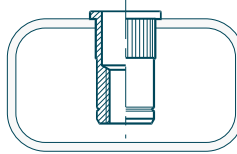
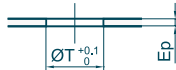
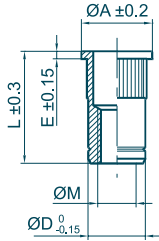

Outillages de pose  
Fastening tools  
se référer à / refer to  
**TOOLIN'FIX**

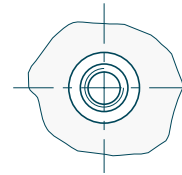

Ø M	Ep min - max	Code	mm ØT	Ø A	L	E	Ø D	X indicative data		daN	N,m	N,m	kg x1000
M2.5 x 0.45	0.0 - 1.1	01M025CCO011X	4.0	6.0	6.9	0.6	4.0	2.4	325	1.0	0.8	0.4	
	1.0 - 1.7	01M025CCO017X	4.0	6.0	7.5	0.6	4.0	3.0	325	1.0	0.8	0.4	
M3 x 0.50	0.0 - 1.1	01M030CCO011X	5.0	7.0	7.4	0.8	5.0	2.3	500	1.4	1.0	0.6	
	0.0 - 1.7	01M030CCO017X	5.0	7.0	8.0	0.8	5.0	2.9	500	1.4	1.0	0.7	
	1.0 - 2.3	01M030CCO023X	5.0	7.0	8.6	0.8	5.0	3.5	500	1.4	1.0	0.7	
	2.3 - 3.0	01M030CCO030X	5.0	7.0	9.2	0.8	5.0	4.1	500	1.4	1.0	0.7	
	0.0 - 1.3	01M040CCO013X	6.0	8.0	9.1	0.8	6.0	2.6	825	3.2	2.1	1.0	
M4 x 0.70	0.8 - 2.1	01M040CCO021X	6.0	8.0	9.8	0.8	6.0	3.3	825	3.2	2.1	1.1	
	1.8 - 3.0	01M040CCO030X	6.0	8.0	10.7	0.8	6.0	4.3	825	3.2	2.1	1.1	
	2.5 - 3.7	01M040CCO037X	6.0	8.0	11.5	0.8	6.0	5.0	825	3.2	2.1	1.2	
	0.0 - 1.5	01M050CCO015X	7.0	9.0	10.5	1.0	7.0	3.1	1150	6.4	3.2	1.5	
	0.5 - 2.5	01M050CCO025X	7.0	9.0	11.5	1.0	7.0	4.1	1150	6.4	3.2	1.6	
M5 x 0.80	1.5 - 3.5	01M050CCO035X	7.0	9.0	12.2	1.0	7.0	5.1	1150	6.4	3.2	1.7	
	3.0 - 4.5	01M050CCO045X	7.0	9.0	13.5	1.0	7.0	6.1	1150	6.4	3.2	1.8	
	0.0 - 1.5	01M060CCO015X	9.0	11.0	13.0	1.2	9.0	3.5	1950	11.1	6.0	3.4	
	0.5 - 2.5	01M060CCO025X	9.0	11.0	14.0	1.2	9.0	4.5	1950	11.1	6.0	3.5	
	1.5 - 3.5	01M060CCO035X	9.0	11.0	15.0	1.2	9.0	5.5	1950	11.1	6.0	3.7	
M6 x 1.00	2.5 - 4.5	01M060CCO045X	9.0	11.0	16.1	1.2	9.0	6.5	1950	11.1	6.0	3.9	
	3.5 - 5.5	01M060CCO055X	9.0	11.0	17.1	1.2	9.0	7.5	1950	11.1	6.0	4.0	
	0.0 - 1.8	01M080CCO018X	11.0	14.0	15.7	1.5	11.0	4.0	3200	27	10.5	5.7	
	1.0 - 3.0	01M080CCO030X	11.0	14.0	16.9	1.5	11.0	5.2	3200	27	10.5	5.9	
	2.2 - 4.2	01M080CCO042X	11.0	14.0	18.1	1.5	11.0	6.4	3200	27	10.5	6.2	
M8 x 1.25	3.0 - 5.0	01M080CCO050X	11.0	14.0	18.9	1.5	11.0	7.2	3200	27	10.5	6.3	
	4.5 - 6.5	01M080CCO065X	11.0	14.0	20.4	1.5	11.0	8.7	3200	27	10.5	6.7	
	0.0 - 2.5	01M100CCO025X	13.0	16.0	19.8	1.5	13.0	5.5	4350	53	16.4	8.9	
	1.0 - 4.0	01M100CCO040X	13.0	16.0	21.3	1.5	13.0	7.0	4350	53	16.4	9.4	
	2.5 - 5.5	01M100CCO055X	13.0	16.0	22.8	1.5	13.0	8.5	4350	53	16.4	9.8	
M10 x 1.50	4.5 - 7.0	01M100CCO070X	13.0	16.0	24.3	1.5	13.0	10.0	4350	53	16.4	10.2	
	0.0 - 4.2	01M120CCO042X	16.0	20.0	23.3	1.7	16.0	8.1	6500	92	23.5	15.2	
	2.5 - 6.0	01M120CCO060X	16.0	20.0	26.0	1.7	16.0	9.9	6500	92	23.5	16.6	
	4.0 - 7.6	01M120CCO076X	16.0	20.0	28.5	1.7	16.0	11.5	6500	92	23.5	18.1	
	7.0 - 9.2	01M120CCO092X	16.0	20.0	30.1	1.7	16.0	13.1	6500	92	23.5	18.7	
M14 x 2.00	0.0 - 3.0	01M140CCO030X	18.0	23.0	26.9	2.0	18.0	7.3	7800	148	31.5	23.7	
	2.0 - 5.0	01M140CCO050X	18.0	23.0	28.6	2.0	18.0	9.3	7800	148	31.5	24.9	
	4.0 - 7.0	01M140CCO070X	18.0	23.0	30.6	2.0	18.0	11.3	7800	148	31.5	26.2	
	7.0 - 9.0	01M140CCO090X	18.0	23.0	32.6	2.0	18.0	13.3	7800	148	31.5	27.5	
M16 x 2.00	0.0 - 3.2	01M160CCO032X	21.0	26.0	28.0	2.5	21.0	8.4	10500	232	41	33.1	
	1.0 - 5.7	01M160CCO057X	21.0	26.0	30.5	2.5	21.0	10.9	10500	232	41	35.0	
	3.5 - 8.2	01M160CCO082X	21.0	26.0	33.0	2.5	21.0	13.4	10500	232	41	36.9	
	7.0 - 11.0	01M160CCO110X	21.0	26.0	35.8	2.5	21.0	16.2	10500	232	41	39.0	

Écrou à sertir en aveugle correspondant à l'ancienne désignation C ... CO ... INOX MOLYBDENE  
Blind Rivet Nuts corresponding to old designation C ... CO ... MOLYBDENUM STAINLESS STEEL