

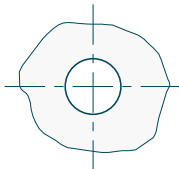

Écrous à sertir en aveugle Blind Rivet Nuts

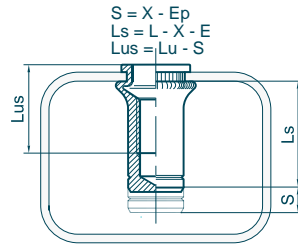

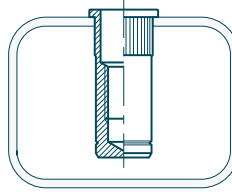

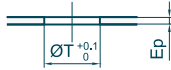
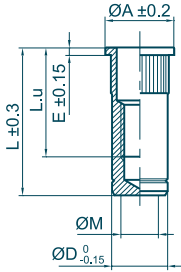

Material : 316L Stainless Steel Matière : Inox 316L
 Head : Flange Tête : Cylindrique
 Body : Knurled Fût : Cannelé
 Body end : Closed End Extrémité du fût : Borgne

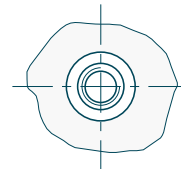

Outillages de pose
Fastening tools
se référer à / refer to
TOOLIN'FIX



| Ø M | Ep | | Code | mm ØT | Ø A | L | L.u | E | Ø D | X indicative data |  |  |  |  |
|-------------|------------|-----|---------------|----------|------|------|------|-----|------|----------------------|---|--|---|---|
| | min | max | | | | | | | | | | | | |
| M2.5 x 0.45 | 0.0 - 1.1 | | 01M025CCB011X | 4.0 | 6.0 | 10.1 | 6.0 | 0.6 | 4.0 | 2.4 | 325 | 1.0 | 0.8 | 0.6 |
| | 1.0 - 1.7 | | 01M025CCB017X | 4.0 | 6.0 | 10.8 | 7.0 | 0.6 | 4.0 | 3.0 | 325 | 1.0 | 0.8 | 0.6 |
| M3 x 0.50 | 0.0 - 1.1 | | 01M030CCB011X | 5.0 | 7.0 | 11.4 | 8.0 | 0.8 | 5.0 | 2.3 | 500 | 1.4 | 1.0 | 1.1 |
| | 0.0 - 1.7 | | 01M030CCB017X | 5.0 | 7.0 | 12.0 | 8.5 | 0.8 | 5.0 | 2.9 | 500 | 1.4 | 1.0 | 1.2 |
| | 1.0 - 2.3 | | 01M030CCB023X | 5.0 | 7.0 | 12.6 | 9.0 | 0.8 | 5.0 | 3.5 | 500 | 1.4 | 1.0 | 1.2 |
| | 2.3 - 3.0 | | 01M030CCB030X | 5.0 | 7.0 | 13.1 | 9.4 | 0.8 | 5.0 | 4.1 | 500 | 1.4 | 1.0 | 1.2 |
| M4 x 0.70 | 0.0 - 1.3 | | 01M040CCB013X | 6.0 | 8.0 | 14.8 | 9.0 | 0.8 | 6.0 | 2.6 | 825 | 3.2 | 2.1 | 2.0 |
| | 0.8 - 2.1 | | 01M040CCB021X | 6.0 | 8.0 | 15.5 | 9.4 | 0.8 | 6.0 | 3.3 | 825 | 3.2 | 2.1 | 2.0 |
| | 1.8 - 3.0 | | 01M040CCB030X | 6.0 | 8.0 | 16.5 | 10.6 | 0.8 | 6.0 | 4.3 | 825 | 3.2 | 2.1 | 2.0 |
| | 2.5 - 3.7 | | 01M040CCB037X | 6.0 | 8.0 | 17.2 | 11.3 | 0.8 | 6.0 | 5.0 | 825 | 3.2 | 2.1 | 2.1 |
| M5 x 0.80 | 0.0 - 1.5 | | 01M050CCB015X | 7.0 | 9.0 | 17.0 | 10.0 | 1.0 | 7.0 | 3.1 | 1150 | 6.4 | 3.2 | 2.9 |
| | 0.5 - 2.5 | | 01M050CCB025X | 7.0 | 9.0 | 18.0 | 11.0 | 1.0 | 7.0 | 4.1 | 1150 | 6.4 | 3.2 | 3.0 |
| | 1.5 - 3.5 | | 01M050CCB035X | 7.0 | 9.0 | 19.0 | 12.0 | 1.0 | 7.0 | 5.1 | 1150 | 6.4 | 3.2 | 3.0 |
| | 3.0 - 4.5 | | 01M050CCB045X | 7.0 | 9.0 | 20.0 | 13.0 | 1.0 | 7.0 | 6.1 | 1150 | 6.4 | 3.2 | 3.1 |
| M6 x 1.00 | 0.0 - 1.5 | | 01M060CCB015X | 9.0 | 11.0 | 21.0 | 13.0 | 1.2 | 9.0 | 3.5 | 1950 | 11.1 | 6.0 | 6.3 |
| | 0.5 - 2.5 | | 01M060CCB025X | 9.0 | 11.0 | 22.0 | 13.6 | 1.2 | 9.0 | 4.5 | 1950 | 11.1 | 6.0 | 6.5 |
| | 1.5 - 3.5 | | 01M060CCB035X | 9.0 | 11.0 | 23.0 | 14.5 | 1.2 | 9.0 | 5.5 | 1950 | 11.1 | 6.0 | 6.6 |
| | 2.5 - 4.5 | | 01M060CCB045X | 9.0 | 11.0 | 23.9 | 15.4 | 1.2 | 9.0 | 6.5 | 1950 | 11.1 | 6.0 | 6.7 |
| M8 x 1.25 | 3.5 - 5.5 | | 01M060CCB055X | 9.0 | 11.0 | 25.0 | 16.5 | 1.2 | 9.0 | 7.5 | 1950 | 11.1 | 6.0 | 6.9 |
| | 0.0 - 1.8 | | 01M080CCB018X | 11.0 | 14.0 | 24.4 | 15.5 | 1.5 | 11.0 | 4.0 | 3200 | 27 | 10.5 | 10.1 |
| | 1.0 - 3.0 | | 01M080CCB030X | 11.0 | 14.0 | 25.6 | 17.3 | 1.5 | 11.0 | 5.2 | 3200 | 27 | 10.5 | 10.4 |
| | 2.2 - 4.2 | | 01M080CCB042X | 11.0 | 14.0 | 26.8 | 17.9 | 1.5 | 11.0 | 6.4 | 3200 | 27 | 10.5 | 10.6 |
| M10 x 1.50 | 3.0 - 5.0 | | 01M080CCB050X | 11.0 | 14.0 | 27.6 | 18.7 | 1.5 | 11.0 | 7.2 | 3200 | 27 | 10.5 | 10.9 |
| | 4.5 - 6.5 | | 01M080CCB065X | 11.0 | 14.0 | 29.1 | 20.2 | 1.5 | 11.0 | 8.7 | 3200 | 27 | 10.5 | 11.1 |
| | 0.0 - 2.5 | | 01M100CCB025X | 13.0 | 16.0 | 31.5 | 20.0 | 1.5 | 13.0 | 5.5 | 4350 | 53 | 16.4 | 16.8 |
| | 1.0 - 4.0 | | 01M100CCB040X | 13.0 | 16.0 | 33.3 | 21.5 | 1.5 | 13.0 | 7.0 | 4350 | 53 | 16.4 | 17.3 |
| M12 x 1.75 | 2.5 - 5.5 | | 01M100CCB055X | 13.0 | 16.0 | 34.3 | 23.0 | 1.5 | 13.0 | 8.5 | 4350 | 53 | 16.4 | 17.5 |
| | 4.5 - 7.0 | | 01M100CCB070X | 13.0 | 16.0 | 35.8 | 25.0 | 1.5 | 13.0 | 10.0 | 4350 | 53 | 16.4 | 17.9 |
| | 0.0 - 4.2 | | 01M120CCB042X | 16.0 | 20.0 | 36.0 | 23.4 | 1.7 | 16.0 | 8.1 | 6500 | 92 | 23.5 | 29.3 |
| | 2.5 - 6.0 | | 01M120CCB060X | 16.0 | 20.0 | 38.8 | 26.2 | 1.7 | 16.0 | 9.9 | 6500 | 92 | 23.5 | 30.0 |
| M14 x 2.00 | 4.0 - 7.6 | | 01M120CCB076X | 16.0 | 20.0 | 40.4 | 27.5 | 1.7 | 16.0 | 11.5 | 6500 | 92 | 23.5 | 30.7 |
| | 7.0 - 9.2 | | 01M120CCB092X | 16.0 | 20.0 | 41.2 | 28.4 | 1.7 | 16.0 | 13.1 | 6500 | 92 | 23.5 | 31.3 |
| | 0.0 - 3.0 | | 01M140CCB030X | 18.0 | 23.0 | 41.3 | 27.3 | 2.0 | 18.0 | 7.3 | 7800 | 148 | 31.5 | 42.5 |
| | 2.0 - 5.0 | | 01M140CCB050X | 18.0 | 23.0 | 43.3 | 29.3 | 2.0 | 18.0 | 9.3 | 7800 | 148 | 31.5 | 43.7 |
| M16 x 2.00 | 4.0 - 7.0 | | 01M140CCB070X | 18.0 | 23.0 | 45.5 | 31.5 | 2.0 | 18.0 | 11.3 | 7800 | 148 | 31.5 | 45.0 |
| | 7.0 - 9.0 | | 01M140CCB090X | 18.0 | 23.0 | 47.6 | 33.6 | 2.0 | 18.0 | 13.3 | 7800 | 148 | 31.5 | 46.3 |
| | 0.0 - 3.2 | | 01M160CCB032X | 21.0 | 26.0 | 44.3 | 28.5 | 2.5 | 21.0 | 8.4 | 10500 | 232 | 41 | 61.3 |
| | 1.0 - 5.7 | | 01M160CCB057X | 21.0 | 26.0 | 46.8 | 31.0 | 2.5 | 21.0 | 10.9 | 10500 | 232 | 41 | 63.2 |
| | 3.5 - 8.3 | | 01M160CCB082X | 21.0 | 26.0 | 49.3 | 33.5 | 2.5 | 21.0 | 13.4 | 10500 | 232 | 41 | 65.1 |
| | 7.0 - 11.0 | | 01M160CCB110X | 21.0 | 26.0 | 52.1 | 36.0 | 2.5 | 21.0 | 16.2 | 10500 | 232 | 41 | 67.2 |

Écrou à sertir en aveugle correspondant à l'ancienne désignation C ... CB ... INOX MOLYBDENE
 Blind Rivet Nuts corresponding to old designation C ... CB ... MOLYBDENUM STAINLESS STEEL

