

Écrous à sertir en aveugle Blind Rivet Nuts



Material : Stainless Steel

Matière : Inox

Head : Flange

Tête : Cylindrique

Body : Round

Fût : Cylindrique



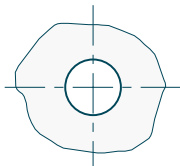
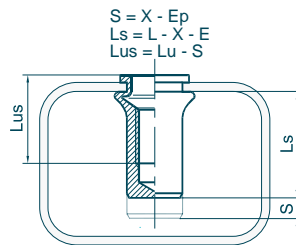
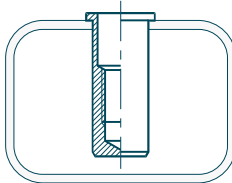
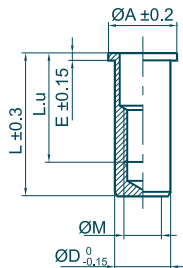

Body end : Closed End

Extrémité du fût : Borgne

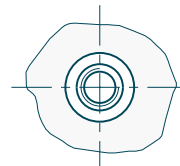

Outillages de pose
Fastening tools
se référer à / refer to
TOOLIN'FIX



Ø M	Ep		Code	mm ØT	Ø A	L	L.u	E	Ø D	X indicative data				
	min	max												
M2.5 x 0.45	0.0 - 1.1		011025CRB011X	4.0	6.0	10.1	6.0	0.6	4.0	2.4	325	1.0	0.8	0.6
	1.0 - 1.7		011025CRB017X	4.0	6.0	10.8	7.0	0.6	4.0	3.0	325	1.0	0.8	0.6
M3 x 0.50	0.0 - 1.1		011030CRB011X	5.0	7.0	11.4	8.0	0.8	5.0	2.3	500	1.4	1.0	1.1
	0.0 - 1.7		011030CRB017X	5.0	7.0	12.0	8.5	0.8	5.0	2.9	500	1.4	1.0	1.2
	1.0 - 2.3		011030CRB023X	5.0	7.0	12.6	9.0	0.8	5.0	3.5	500	1.4	1.0	1.2
M4 x 0.70	2.3 - 3.0		011030CRB030X	5.0	7.0	13.1	9.4	0.8	5.0	4.1	500	1.4	1.0	1.2
	0.0 - 1.3		011040CRB013X	6.0	8.0	14.8	9.0	0.8	6.0	2.6	825	3.2	2.1	2.0
	0.8 - 2.1		011040CRB021X	6.0	8.0	15.5	9.4	0.8	6.0	3.3	825	3.2	2.1	2.0
M5 x 0.80	1.8 - 3.0		011040CRB030X	6.0	8.0	16.5	10.6	0.8	6.0	4.3	825	3.2	2.1	2.0
	2.5 - 3.7		011040CRB037X	6.0	8.0	17.2	11.3	0.8	6.0	5.0	825	3.2	2.1	2.1
	0.0 - 1.5		011050CRB015X	7.0	9.0	17.0	10.0	1.0	7.0	3.1	1150	6.4	3.2	2.9
M6 x 1.00	0.0 - 2.5		011050CRB025X	7.0	9.0	18.0	11.0	1.0	7.0	4.1	1150	6.4	3.2	3.0
	1.0 - 3.5		011050CRB035X	7.0	9.0	19.0	12.0	1.0	7.0	5.1	1150	6.4	3.2	3.0
	3.0 - 4.5		011050CRB045X	7.0	9.0	20.0	13.0	1.0	7.0	6.1	1150	6.4	3.2	3.1
M8 x 1.25	0.0 - 1.5		011060CRB015X	9.0	11.0	21.0	13.0	1.2	9.0	3.5	1950	11.1	6.0	6.3
	0.0 - 2.5		011060CRB025X	9.0	11.0	22.0	13.6	1.2	9.0	4.5	1950	11.1	6.0	6.5
	1.0 - 3.5		011060CRB035X	9.0	11.0	23.0	14.5	1.2	9.0	5.5	1950	11.1	6.0	6.6
M10 x 1.50	2.0 - 4.5		011060CRB045X	9.0	11.0	23.9	15.4	1.2	9.0	6.5	1950	11.1	6.0	6.7
	3.0 - 5.5		011060CRB055X	9.0	11.0	25.0	16.5	1.2	9.0	7.5	1950	11.1	6.0	6.9
	0.0 - 1.8		011080CRB018X	11.0	14.0	24.4	15.5	1.5	11.0	4.0	3200	27	10.5	10.1
M12 x 1.75	0.5 - 3.0		011080CRB030X	11.0	14.0	25.6	17.3	1.5	11.0	5.2	3200	27	10.5	10.4
	1.8 - 4.2		011080CRB042X	11.0	14.0	26.8	17.9	1.5	11.0	6.4	3200	27	10.5	10.6
	2.5 - 5.0		011080CRB050X	11.0	14.0	27.6	18.7	1.5	11.0	7.2	3200	27	10.5	10.9
M14 x 2.00	4.5 - 6.5		011080CRB065X	11.0	14.0	29.1	20.2	1.5	11.0	8.7	3200	27	10.5	11.1
	0.0 - 2.5		011100CRB025X	13.0	16.0	31.5	20.0	1.5	13.0	5.5	4350	53	16.4	16.8
	1.0 - 4.0		011100CRB040X	13.0	16.0	33.3	21.5	1.5	13.0	7.0	4350	53	16.4	17.3
M16 x 2.00	2.5 - 5.5		011100CRB055X	13.0	16.0	34.3	23.0	1.5	13.0	8.5	4350	53	16.4	17.5
	4.5 - 7.0		011100CRB070X	13.0	16.0	35.8	25.0	1.5	13.0	10.0	4350	53	16.4	17.9
	0.0 - 4.2		011120CRB042X	16.0	20.0	36.0	23.4	1.7	16.0	8.1	6500	92	23.5	29.3
M18 x 2.00	2.5 - 6.0		011120CRB060X	16.0	20.0	38.8	26.2	1.7	16.0	9.9	6500	92	23.5	30.0
	4.0 - 7.6		011120CRB076X	16.0	20.0	40.4	27.5	1.7	16.0	11.5	6500	92	23.5	30.7
	7.0 - 9.2		011120CRB092X	16.0	20.0	41.2	28.4	1.7	16.0	13.1	6500	92	23.5	31.3
M20 x 2.00	0.0 - 3.0		011140CRB030X	18.0	23.0	41.3	27.3	2.0	18.0	7.3	7800	148	31.5	42.5
	2.0 - 5.0		011140CRB050X	18.0	23.0	43.3	29.3	2.0	18.0	9.3	7800	148	31.5	43.7
	4.0 - 7.0		011140CRB070X	18.0	23.0	45.5	31.5	2.0	18.0	11.3	7800	148	31.5	45.0
M22 x 2.00	7.0 - 9.0		011140CRB090X	18.0	23.0	47.6	33.6	2.0	18.0	13.3	7800	148	31.5	46.3
	0.0 - 3.2		011160CRB032X	21.0	26.0	44.3	28.5	2.5	21.0	8.4	10500	232	41	61.3
	1.0 - 5.7		011160CRB057X	21.0	26.0	46.8	31.0	2.5	21.0	10.9	10500	232	41	63.2
M24 x 2.00	3.5 - 8.3		011160CRB082X	21.0	26.0	49.3	33.5	2.5	21.0	13.4	10500	232	41	65.1
	7.0 - 11.0		011160CRB110X	21.0	26.0	52.1	36.0	2.5	21.0	16.2	10500	232	41	67.2

Écrou à sertir en aveugle correspondant à l'ancienne désignation M ... CB ... INOX
Blind Rivet Nuts corresponding to old designation M ... CB ... STAINLESS STEEL