

Écrous à sertir en aveugle Blind Rivet Nuts



Material : Steel

Matière : Acier

Head : Countersunk

Tête : Fraisée

Body : Round

Fût : Cylindrique

Body end : Closed End

Extrémité du fût : Borgne

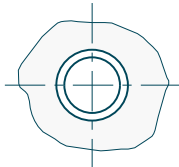
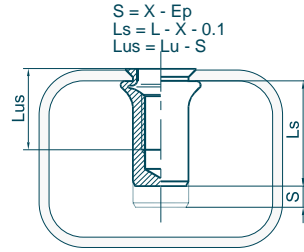
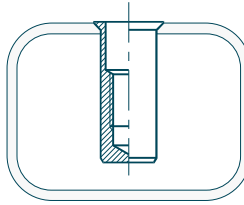
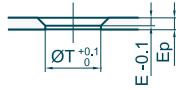
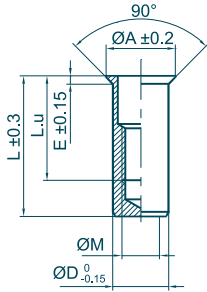

Outillages de pose
Fastening tools
se référer à / refer to
TOOLIN'FIX

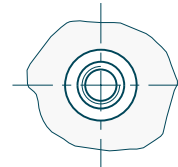

Ø M	Ep		Code	mm		Ø A	L	L.u	E	Ø D	X	daN	N.m	N.m	kg x1000
	min	max		ØT	ØA										
M2.5 x 0.45	0.8 - 1.7		01A025FRB017Z	4.0	5.0	10.3	6.5	0.6	4.0	3.0	300	1.0	0.8	0.6	
M3 x 0.50	1.1 - 1.7		01A030FRB017Z	5.0	6.8	12.3	7.0	1.0	5.0	2.8	450	1.4	1.0	1.2	
	1.1 - 2.3		01A030FRB023Z	5.0	6.8	12.9	8.0	1.0	5.0	3.4	450	1.4	1.0	1.2	
	1.8 - 3.0		01A030FRB030Z	5.0	6.8	13.5	9.0	1.0	5.0	4.0	450	1.4	1.0	1.2	
	1.1 - 2.1		01A040FRB021Z	6.0	7.8	15.9	9.5	1.0	6.0	3.4	750	3.2	2.1	2.0	
M4 x 0.70	1.1 - 3.0		01A040FRB030Z	6.0	7.8	16.8	10.6	1.0	6.0	4.3	750	3.2	2.1	2.1	
	1.3 - 3.7		01A040FRB037Z	6.0	7.8	17.5	11.0	1.0	6.0	5.0	750	3.2	2.1	2.1	
	1.1 - 2.5		01A050FRB025Z	7.0	8.8	18.3	12.0	1.0	7.0	4.0	1080	6.4	3.2	3.0	
	1.1 - 3.5		01A050FRB035Z	7.0	8.8	19.3	13.0	1.0	7.0	5.0	1080	6.4	3.2	3.1	
M5 x 0.80	1.5 - 4.5		01A050FRB045Z	7.0	8.8	20.3	14.0	1.0	7.0	6.0	1080	6.4	3.2	3.1	
	1.1 - 2.5		01A060FRB025Z	9.0	10.8	22.3	13.5	1.0	9.0	4.4	1800	11.1	6.0	6.5	
	1.1 - 3.5		01A060FRB035Z	9.0	10.8	23.3	14.5	1.0	9.0	5.4	1800	11.1	6.0	6.7	
	2.0 - 4.5		01A060FRB045Z	9.0	10.8	24.3	15.5	1.0	9.0	6.4	1800	11.1	6.0	6.8	
M6 x 1.00	3.0 - 5.5		01A060FRB055Z	9.0	10.8	25.3	16.5	1.0	9.0	7.4	1800	11.1	6.0	7.0	
	1.8 - 3.0		01A080FRB030Z	11.0	13.8	25.3	16.1	1.5	11.0	4.9	2950	27	10.5	10.2	
	1.8 - 4.2		01A080FRB042Z	11.0	13.8	26.5	18.1	1.5	11.0	6.1	2950	27	10.5	10.5	
	2.0 - 5.0		01A080FRB050Z	11.0	13.8	27.3	18.7	1.5	11.0	6.9	2950	27	10.5	10.7	
M8 x 1.25	3.5 - 6.5		01A080FRB065Z	11.0	13.8	28.8	20.0	1.5	11.0	8.4	2950	27	10.5	11.0	
	1.8 - 4.0		01A100FRB040Z	13.0	15.8	32.9	21.0	1.5	13.0	6.8	4000	53	16.4	17.0	
	2.0 - 5.5		01A100FRB055Z	13.0	15.8	34.4	22.0	1.5	13.0	8.3	4000	53	16.4	17.5	
	4.0 - 7.0		01A100FRB070Z	13.0	15.8	35.9	24.0	1.5	13.0	9.8	4000	53	16.4	17.9	
M10 x 1.50	2.5 - 4.2		01A120FRB042Z	16.0	19.8	36.3	23.7	2.0	16.0	7.3	6100	92	23.5	29.3	
	2.5 - 6.0		01A120FRB060Z	16.0	19.8	38.1	25.7	2.0	16.0	9.1	6100	92	23.5	30.0	
	3.5 - 7.6		01A120FRB076Z	16.0	19.8	39.7	28.0	2.0	16.0	10.7	6100	92	23.5	30.6	
	6.0 - 9.2		01A120FRB092Z	16.0	19.8	41.1	29.4	2.0	16.0	12.3	6100	92	23.5	31.2	
M12 x 1.75	1.0 - 5.0		01A140FRB050Z	18.0	22.8	43.4	29.4	2.5	18.0	9.0	7200	148	31.5	43.4	
	3.0 - 7.0		01A140FRB070Z	18.0	22.8	45.6	31.6	2.5	18.0	11.0	7200	148	31.5	44.7	
	6.0 - 9.0		01A140FRB090Z	18.0	22.8	47.7	33.7	2.5	18.0	13.0	7200	148	31.5	46.0	
	3.0 - 5.7		01A160FRB057Z	21.0	25.8	46.4	30.5	2.5	21.0	10.7	10000	232	41	62.0	
M16 x 2.00	2.0 - 8.2		01A160FRB082Z	21.0	25.8	48.9	33.0	2.5	21.0	13.2	10000	232	41	63.9	
	6.0 - 11.0		01A160FRB110Z	21.0	25.8	51.7	35.5	2.5	21.0	16.0	10000	232	41	66.1	

Écrou à sertir en aveugle correspondant à l'ancienne désignation M ... FB ... ACIER
Blind Rivet Nuts corresponding to old designation M ... FB ... STEEL