

Écrous à sertir en aveugle Blind Rivet Nuts



Material : Steel

Matière : Acier

Head : Flange

Tête : Cylindrique

Body : Round

Fût : Cylindrique



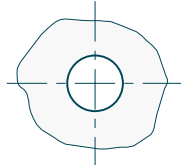
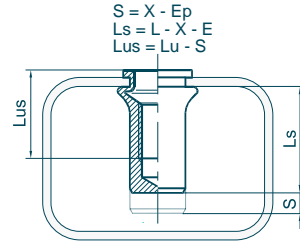
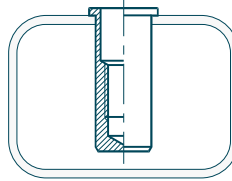
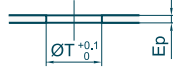
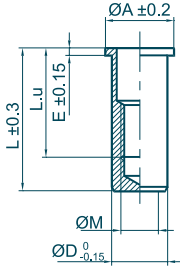

Body end : Closed End

Extrémité du fût : Borgne

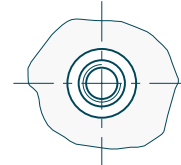

Outillages de pose
Fastening tools
se référer à / refer to
TOOLIN'FIX



| Ø M | Ep | | Code | mm ØT | Ø A | L | L.u | E | Ø D | X indicative data |  |  |  |  |
|-------------|-----------|---------------|---------------|----------|------|------|------|------|------|----------------------|---|--|---|---|
| | min | max | | | | | | | | | | | | |
| M2.5 x 0.45 | 0.0 - 1.1 | 0.8 - 1.7 | 01A025CRB011Z | 4.0 | 6.0 | 10.2 | 6.1 | 0.6 | 4.0 | 2.4 | 300 | 1.0 | 0.8 | 0.6 |
| | 0.0 - 1.1 | 0.8 - 1.7 | 01A025CRB017Z | 4.0 | 6.0 | 10.8 | 7.0 | 0.6 | 4.0 | 3.0 | 300 | 1.0 | 0.8 | 0.6 |
| M3 x 0.50 | 0.0 - 1.1 | 0.8 - 1.7 | 01A030CRB011Z | 5.0 | 7.0 | 12.4 | 7.0 | 0.8 | 5.0 | 2.2 | 450 | 1.4 | 1.0 | 1.2 |
| | 0.0 - 1.7 | 1.0 - 2.3 | 01A030CRB017Z | 5.0 | 7.0 | 13.0 | 7.5 | 0.8 | 5.0 | 2.8 | 450 | 1.4 | 1.0 | 1.3 |
| | 1.0 - 2.3 | 1.8 - 3.0 | 01A030CRB023Z | 5.0 | 7.0 | 13.6 | 8.5 | 0.8 | 5.0 | 3.4 | 450 | 1.4 | 1.0 | 1.3 |
| | 1.8 - 3.0 | 0.0 - 1.7 | 01A030CRB030Z | 5.0 | 7.0 | 14.2 | 8.7 | 0.8 | 5.0 | 4.0 | 450 | 1.4 | 1.0 | 1.3 |
| M4 x 0.70 | 0.0 - 1.3 | 0.0 - 2.1 | 01A040CRB013Z | 6.0 | 8.0 | 15.8 | 9.5 | 0.8 | 6.0 | 2.6 | 750 | 3.2 | 2.1 | 2.1 |
| | 0.0 - 2.1 | 1.3 - 3.7 | 01A040CRB021Z | 6.0 | 8.0 | 16.6 | 10.0 | 0.8 | 6.0 | 3.4 | 750 | 3.2 | 2.1 | 2.1 |
| | 0.5 - 3.0 | 0.0 - 1.3 | 01A040CRB030Z | 6.0 | 8.0 | 17.5 | 11.1 | 0.8 | 6.0 | 4.3 | 750 | 3.2 | 2.1 | 2.2 |
| | 1.3 - 3.7 | 0.0 - 1.3 | 01A040CRB037Z | 6.0 | 8.0 | 18.2 | 12.0 | 0.8 | 6.0 | 5.0 | 750 | 3.2 | 2.1 | 2.2 |
| M5 x 0.80 | 0.0 - 1.5 | 0.0 - 2.5 | 01A050CRB015Z | 7.0 | 9.0 | 18.2 | 11.0 | 1.0 | 7.0 | 3.0 | 1050 | 6.4 | 3.2 | 3.1 |
| | 0.0 - 2.5 | 0.5 - 3.5 | 01A050CRB025Z | 7.0 | 9.0 | 19.2 | 12.0 | 1.0 | 7.0 | 4.0 | 1050 | 6.4 | 3.2 | 3.2 |
| | 0.5 - 3.5 | 1.5 - 4.5 | 01A050CRB035Z | 7.0 | 9.0 | 20.2 | 13.0 | 1.0 | 7.0 | 5.0 | 1050 | 6.4 | 3.2 | 3.3 |
| | 1.5 - 4.5 | 0.0 - 1.5 | 01A050CRB045Z | 7.0 | 9.0 | 21.2 | 14.0 | 1.0 | 7.0 | 6.0 | 1050 | 6.4 | 3.2 | 3.3 |
| M6 x 1.00 | 0.0 - 1.5 | 0.0 - 2.5 | 01A060CRB015Z | 9.0 | 11.0 | 22.4 | 14.0 | 1.2 | 9.0 | 3.4 | 1800 | 11.1 | 6.0 | 6.7 |
| | 0.0 - 2.5 | 1.0 - 3.5 | 01A060CRB025Z | 9.0 | 11.0 | 23.4 | 15.0 | 1.2 | 9.0 | 4.4 | 1800 | 11.1 | 6.0 | 6.9 |
| | 1.0 - 3.5 | 2.0 - 4.5 | 01A060CRB035Z | 9.0 | 11.0 | 24.4 | 16.5 | 1.2 | 9.0 | 5.4 | 1800 | 11.1 | 6.0 | 7.0 |
| | 2.0 - 4.5 | 3.0 - 5.5 | 01A060CRB045Z | 9.0 | 11.0 | 25.4 | 17.5 | 1.2 | 9.0 | 6.4 | 1800 | 11.1 | 6.0 | 7.2 |
| M8 x 1.25 | 0.0 - 1.8 | 0.0 - 3.0 | 01A080CRB018Z | 11.0 | 14.0 | 25.5 | 17.1 | 1.5 | 11.0 | 3.7 | 2950 | 27 | 10.5 | 10.6 |
| | 0.0 - 3.0 | 1.2 - 4.2 | 01A080CRB030Z | 11.0 | 14.0 | 26.7 | 18.1 | 1.5 | 11.0 | 4.9 | 2950 | 27 | 10.5 | 10.9 |
| | 1.2 - 4.2 | 2.0 - 5.0 | 01A080CRB042Z | 11.0 | 14.0 | 27.9 | 19.1 | 1.5 | 11.0 | 6.1 | 2950 | 27 | 10.5 | 11.2 |
| | 2.0 - 5.0 | 3.5 - 6.5 | 01A080CRB050Z | 11.0 | 14.0 | 28.7 | 19.7 | 1.5 | 11.0 | 6.9 | 2950 | 27 | 10.5 | 11.5 |
| M10 x 1.50 | 0.0 - 2.5 | 0.5 - 4.0 | 01A100CRB065Z | 11.0 | 14.0 | 30.2 | 21.0 | 1.5 | 11.0 | 8.4 | 2950 | 27 | 10.5 | 11.7 |
| | 0.0 - 2.5 | 4.0 - 7.0 | 01A100CRB025Z | 13.0 | 16.0 | 32.8 | 21.0 | 1.5 | 13.0 | 5.3 | 4000 | 53 | 16.4 | 17.4 |
| | 0.5 - 4.0 | 2.0 - 5.5 | 01A100CRB040Z | 13.0 | 16.0 | 34.3 | 22.5 | 1.5 | 13.0 | 6.8 | 4000 | 53 | 16.4 | 17.9 |
| | 2.0 - 5.5 | 4.0 - 7.0 | 01A100CRB055Z | 13.0 | 16.0 | 35.8 | 24.0 | 1.5 | 13.0 | 8.3 | 4000 | 53 | 16.4 | 18.3 |
| M12 x 1.75 | 0.0 - 4.2 | 0.0 - 7.0 | 01A100CRB070Z | 13.0 | 16.0 | 37.3 | 27.0 | 1.5 | 13.0 | 9.8 | 4000 | 53 | 16.4 | 18.6 |
| | 0.0 - 4.2 | 2.0 - 6.0 | 01A120CRB042Z | 16.0 | 20.0 | 37.9 | 25.4 | 1.7 | 16.0 | 7.3 | 6100 | 92 | 23.5 | 30.6 |
| | 2.0 - 6.0 | 3.5 - 7.6 | 01A120CRB060Z | 16.0 | 20.0 | 39.7 | 27.2 | 1.7 | 16.0 | 9.1 | 6100 | 92 | 23.5 | 31.3 |
| | 3.5 - 7.6 | 6.0 - 9.2 | 01A120CRB076Z | 16.0 | 20.0 | 41.3 | 28.5 | 1.7 | 16.0 | 10.7 | 6100 | 92 | 23.5 | 32.1 |
| M14 x 2.00 | 0.0 - 9.2 | 0.0 - 3.0 | 01A120CRB092Z | 16.0 | 20.0 | 42.9 | 30.1 | 1.7 | 16.0 | 12.3 | 6100 | 92 | 23.5 | 32.7 |
| | 0.0 - 3.0 | 1.0 - 5.0 | 01A140CRB030Z | 18.0 | 23.0 | 43.6 | 29.6 | 2.0 | 18.0 | 7.0 | 7200 | 148 | 31.5 | 44.4 |
| | 1.0 - 5.0 | 3.0 - 7.0 | 01A140CRB050Z | 18.0 | 23.0 | 45.5 | 31.5 | 2.0 | 18.0 | 9.0 | 7200 | 148 | 31.5 | 45.6 |
| | 3.0 - 7.0 | 6.0 - 9.0 | 01A140CRB070Z | 18.0 | 23.0 | 47.5 | 33.5 | 2.0 | 18.0 | 11.0 | 7200 | 148 | 31.5 | 46.9 |
| M16 x 2.00 | 6.0 - 9.0 | 0.0 - 3.2 | 01A140CRB090Z | 18.0 | 23.0 | 49.5 | 35.5 | 2.0 | 18.0 | 13.0 | 7200 | 148 | 31.5 | 48.2 |
| | 0.0 - 3.2 | 0.0 - 5.7 | 01A160CRB032Z | 21.0 | 26.0 | 46.3 | 30.5 | 2.5 | 21.0 | 8.2 | 10000 | 232 | 41 | 63.9 |
| | 0.0 - 5.7 | 2.0 - 8.2 | 01A160CRB057Z | 21.0 | 26.0 | 48.8 | 33.0 | 2.5 | 21.0 | 10.7 | 10000 | 232 | 41 | 65.8 |
| | 2.0 - 8.2 | 6.0 - 11.0 | 01A160CRB082Z | 21.0 | 26.0 | 51.3 | 35.5 | 2.5 | 21.0 | 13.2 | 10000 | 232 | 41 | 67.7 |
| 6.0 - 11.0 | | 01A160CRB110Z | 21.0 | 26.0 | 54.1 | 38.0 | 2.5 | 21.0 | 16.0 | 10000 | 232 | 41 | 69.9 | |

Écrou à sertir en aveugle correspondant à l'ancienne désignation M ... CB ... ACIER
Blind Rivet Nuts corresponding to old designation M ... CB ... STEEL

