



Écrous à sertir en aveugle Blind Rivet Nuts

Material : Steel

Matière : Acier

Head : Flange

Tête : Cylindrique

Body : Knurled

Fût : Cannelé

Body end : Closed End

Extrémité du fût : Borgne

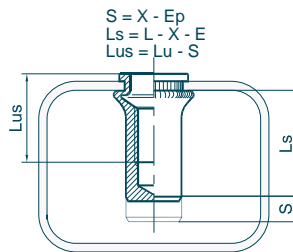
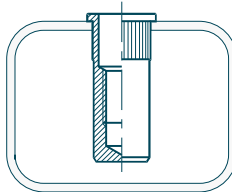
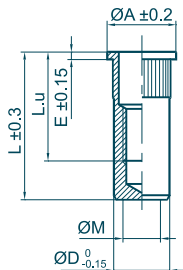

Outillages de pose
Fastening tools
se référer à / refer to
TOOLIN'FIX

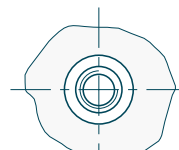

Ø M	Ep		Code	mm ØT	Ø A	L	L.u	E	Ø D	X indicative data				
	min	max												
M2.5 x 0.45	0.0 - 1.1	0.1A025CCB011Z	4.0	6.0	10.2	6.1	0.6	4.0	2.4	300	1.0	0.8	0.6	
	1.1 - 1.7	0.1A025CCB017Z	4.0	6.0	10.8	7.0	0.6	4.0	3.0	300	1.0	0.8	0.6	
M3 x 0.50	0.0 - 1.1	0.1A030CCB011Z	5.0	7.0	12.4	7.0	0.8	5.0	2.2	450	1.4	1.0	1.2	
	0.0 - 1.7	0.1A030CCB017Z	5.0	7.0	13.0	7.5	0.8	5.0	2.8	450	1.4	1.0	1.3	
	1.0 - 2.3	0.1A030CCB023Z	5.0	7.0	13.6	8.5	0.8	5.0	3.4	450	1.4	1.0	1.3	
	1.8 - 3.0	0.1A030CCB030Z	5.0	7.0	14.2	8.7	0.8	5.0	4.0	450	1.4	1.0	1.3	
M4 x 0.70	0.0 - 1.3	0.1A040CCB013Z	6.0	8.0	15.8	9.5	0.8	6.0	2.6	750	3.2	2.1	2.1	
	0.0 - 2.1	0.1A040CCB021Z	6.0	8.0	16.6	10.0	0.8	6.0	3.4	750	3.2	2.1	2.1	
	1.0 - 3.0	0.1A040CCB030Z	6.0	8.0	17.5	11.1	0.8	6.0	4.3	750	3.2	2.1	2.2	
	1.7 - 3.7	0.1A040CCB037Z	6.0	8.0	18.2	12.0	0.8	6.0	5.0	750	3.2	2.1	2.2	
M5 x 0.80	0.0 - 1.5	0.1A050CCB015Z	7.0	9.0	18.2	11.0	1.0	7.0	3.0	1050	6.4	3.2	3.1	
	0.0 - 2.5	0.1A050CCB025Z	7.0	9.0	19.2	12.0	1.0	7.0	4.0	1050	6.4	3.2	3.2	
	1.5 - 3.5	0.1A050CCB035Z	7.0	9.0	20.2	13.0	1.0	7.0	5.0	1050	6.4	3.2	3.3	
	2.5 - 4.5	0.1A050CCB045Z	7.0	9.0	21.2	14.0	1.0	7.0	6.0	1050	6.4	3.2	3.3	
M6 x 1.00	0.0 - 1.5	0.1A060CCB015Z	9.0	11.0	22.4	14.0	1.2	9.0	3.4	1800	11.1	6.0	6.7	
	0.5 - 2.5	0.1A060CCB025Z	9.0	11.0	23.4	15.0	1.2	9.0	4.4	1800	11.1	6.0	6.9	
	1.5 - 3.5	0.1A060CCB035Z	9.0	11.0	24.4	16.5	1.2	9.0	5.4	1800	11.1	6.0	7.0	
	2.5 - 4.5	0.1A060CCB045Z	9.0	11.0	25.4	17.5	1.2	9.0	6.4	1800	11.1	6.0	7.2	
M8 x 1.25	3.5 - 5.5	0.1A060CCB055Z	9.0	11.0	26.4	18.5	1.2	9.0	7.4	1800	11.1	6.0	7.3	
	0.0 - 1.8	0.1A080CCB018Z	11.0	14.0	25.5	17.1	1.5	11.0	3.7	2950	27	10.5	10.6	
	1.0 - 3.0	0.1A080CCB030Z	11.0	14.0	26.7	18.1	1.5	11.0	4.9	2950	27	10.5	10.9	
	2.2 - 4.2	0.1A080CCB042Z	11.0	14.0	27.9	19.1	1.5	11.0	6.1	2950	27	10.5	11.2	
M10 x 1.50	3.0 - 5.0	0.1A080CCB050Z	11.0	14.0	28.7	19.7	1.5	11.0	6.9	2950	27	10.5	11.5	
	4.5 - 6.5	0.1A080CCB065Z	11.0	14.0	30.2	21.0	1.5	11.0	8.4	2950	27	10.5	11.7	
	0.0 - 2.5	0.1A100CCB025Z	13.0	16.0	32.8	21.0	1.5	13.0	5.3	4000	53	16.4	17.4	
	0.5 - 4.0	0.1A100CCB040Z	13.0	16.0	34.3	22.5	1.5	13.0	6.8	4000	53	16.4	17.9	
M12 x 1.75	2.0 - 5.5	0.1A100CCB055Z	13.0	16.0	35.8	24.0	1.5	13.0	8.3	4000	53	16.4	18.3	
	4.0 - 7.0	0.1A100CCB070Z	13.0	16.0	37.3	27.0	1.5	13.0	9.8	4000	53	16.4	18.6	
	0.0 - 4.2	0.1A120CCB042Z	16.0	20.0	37.9	25.4	1.7	16.0	7.3	6100	92	23.5	30.6	
	2.0 - 6.0	0.1A120CCB060Z	16.0	20.0	39.7	27.2	1.7	16.0	9.1	6100	92	23.5	31.3	
M14 x 2.00	3.5 - 7.6	0.1A120CCB076Z	16.0	20.0	41.3	28.5	1.7	16.0	10.7	6100	92	23.5	32.1	
	6.0 - 9.2	0.1A120CCB092Z	16.0	20.0	42.9	30.1	1.7	16.0	12.3	6100	92	23.5	32.7	
	0.0 - 3.0	0.1A140CCB030Z	18.0	23.0	43.6	29.6	2.0	18.0	7.0	7200	148	31.5	44.4	
	1.0 - 5.0	0.1A140CCB050Z	18.0	23.0	45.5	31.5	2.0	18.0	9.0	7200	148	31.5	45.6	
M16 x 2.00	3.0 - 7.0	0.1A140CCB070Z	18.0	23.0	47.5	33.5	2.0	18.0	11.0	7200	148	31.5	46.9	
	6.0 - 9.0	0.1A140CCB090Z	18.0	23.0	49.5	35.5	2.0	18.0	13.0	7200	148	31.5	48.2	
	0.0 - 3.2	0.1A160CCB032Z	21.0	26.0	46.3	30.5	2.5	21.0	8.2	10000	232	41	63.9	
	0.0 - 5.7	0.1A160CCB057Z	21.0	26.0	48.8	33.0	2.5	21.0	10.7	10000	232	41	65.8	
M16 x 2.00	2.0 - 8.2	0.1A160CCB082Z	21.0	26.0	51.3	35.5	2.5	21.0	13.2	10000	232	41	67.7	
	6.0 - 11.0	0.1A160CCB110Z	21.0	26.0	54.1	38.0	2.5	21.0	16.0	10000	232	41	69.9	

Écrou à sertir en aveugle correspondant à l'ancienne désignation C... CB... ACIER
Blind Rivet Nuts corresponding to old designation C... CB... STEEL