

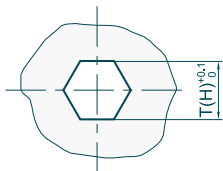

Écrous à sertir en aveugle Blind Rivet Nuts

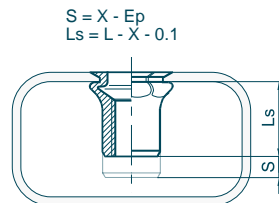

Matière : Acier	Material : Steel
Tête : Affleurante	Head : Flush
Fût : Hexagonal	Body : Hexagonal
Extrémité du fût : Ouvert	Body end : Open Shape

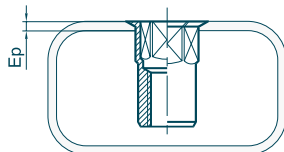
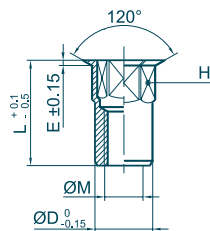

Outillages de pose
Fastening tools
se référer à / refer to
TOOLIN'FIX

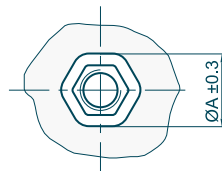

Ø M	Ep min - max	Code	H	mm T(H)	A	L	E	Ø D	X indicative data				
M2.5 x 0.45	0.0 - 1.1	01A025AHO011Z	4.0	4.0	4.6	6.4	0.3	4.0	2.4	300	1.0	1.0	0.3
	1.1 - 1.7	01A025AHO017Z	4.0	4.0	4.6	7.0	0.3	4.0	3.0	300	1.0	1.0	0.3
M3 x 0.50	0.0 - 1.1	01A030AHO011Z	5.0	5.0	5.8	7.2	0.3	5.0	2.4	450	1.4	1.3	0.6
	1.0 - 2.3	01A030AHO023Z	5.0	5.0	5.8	8.6	0.3	5.0	3.6	450	1.4	1.3	0.6
	2.1 - 3.2	01A030AHO032Z	5.0	5.0	5.8	9.7	0.3	5.0	4.7	450	1.4	1.3	0.7
	3.0 - 4.1	01A030AHO041Z	5.0	5.0	5.8	10.6	0.3	5.0	5.6	450	1.4	1.3	0.7
	0.0 - 1.3	01A040AHO013Z	6.0	6.0	6.8	9.4	0.3	6.0	2.6	750	3.2	3.1	1.0
M4 x 0.70	1.0 - 3.0	01A040AHO030Z	6.0	6.0	6.8	11.1	0.3	6.0	4.3	750	3.2	3.1	1.1
	2.2 - 4.2	01A040AHO042Z	6.0	6.0	6.8	12.3	0.3	6.0	5.5	750	3.2	3.1	1.2
	3.0 - 5.5	01A040AHO055Z	6.0	6.0	6.8	13.5	0.3	6.0	6.8	750	3.2	3.1	1.2
	0.0 - 1.5	01A050AHO015Z	7.0	7.0	8.0	10.8	0.4	7.0	3.0	1050	6.4	6.1	1.5
	0.5 - 2.5	01A050AHO025Z	7.0	7.0	8.0	11.8	0.4	7.0	4.0	1050	6.4	6.1	1.5
M5 x 0.80	1.5 - 3.5	01A050AHO035Z	7.0	7.0	8.0	12.8	0.4	7.0	5.0	1050	6.4	6.1	1.6
	2.5 - 4.5	01A050AHO045Z	7.0	7.0	8.0	13.8	0.4	7.0	6.0	1050	6.4	6.1	1.7
	0.0 - 1.5	01A060AHO015Z	9.0	9.0	10.0	13.3	0.4	9.0	3.4	1800	11.1	10.6	3.3
	1.5 - 3.5	01A060AHO035Z	9.0	9.0	10.0	15.3	0.4	9.0	5.4	1800	11.1	10.6	3.6
	2.5 - 4.5	01A060AHO045Z	9.0	9.0	10.0	16.3	0.4	9.0	6.4	1800	11.1	10.6	3.8
M6 x 1.00	3.5 - 5.5	01A060AHO055Z	9.0	9.0	10.0	17.3	0.4	9.0	7.4	1800	11.1	10.6	3.9
	4.5 - 6.5	01A060AHO065Z	9.0	9.0	10.0	18.3	0.4	9.0	8.4	1800	11.1	10.6	4.2
	0.0 - 1.8	01A080AHO018Z	11.0	11.0	12.0	14.7	0.4	11.0	3.7	2950	27	25.8	4.9
	1.0 - 3.0	01A080AHO030Z	11.0	11.0	12.0	15.9	0.4	11.0	4.9	2950	27	25.8	5.1
	2.3 - 4.2	01A080AHO042Z	11.0	11.0	12.0	17.2	0.4	11.0	6.2	2950	27	25.8	5.4
M8 x 1.25	3.0 - 5.0	01A080AHO050Z	11.0	11.0	12.0	17.8	0.4	11.0	6.9	2950	27	25.8	5.6
	4.5 - 6.5	01A080AHO065Z	11.0	11.0	12.0	19.3	0.4	11.0	8.4	2950	27	25.8	5.9
	0.0 - 3.2	01A100AHO032Z	13.0	13.0	14.5	20.6	0.6	13.0	6.0	4000	53	51	8.8
	2.0 - 5.5	01A100AHO055Z	13.0	13.0	14.5	22.9	0.6	13.0	8.3	4000	53	51	9.4
	3.0 - 6.5	01A100AHO065Z	13.0	13.0	14.5	23.9	0.6	13.0	9.3	4000	53	51	9.7
M10 x 1.50	4.5 - 7.5	01A100AHO075Z	13.0	13.0	14.5	24.9	0.6	13.0	10.3	4000	53	51	10.0
	0.0 - 4.2	01A120AHO042Z	16.0	16.0	17.5	24.3	0.6	16.0	7.3	6100	92	88	15.8
	2.0 - 6.0	01A120AHO060Z	16.0	16.0	17.5	26.1	0.6	16.0	9.1	6100	92	88	16.6
	3.5 - 7.6	01A120AHO076Z	16.0	16.0	17.5	27.7	0.6	16.0	10.7	6100	92	88	17.3
	6.0 - 9.2	01A120AHO092Z	16.0	16.0	17.5	29.2	0.6	16.0	12.3	6100	92	88	17.9
M14 x 2.00	0.0 - 3.0	01A140AHO030Z	18.0	18.0	19.5	26.6	0.6	18.0	7.0	7200	148	142	21.9
	1.0 - 5.0	01A140AHO050Z	18.0	18.0	19.5	28.6	0.6	18.0	9.0	7200	148	142	23.1
	3.0 - 7.0	01A140AHO070Z	18.0	18.0	19.5	30.6	0.6	18.0	11.0	7200	148	142	24.4
	6.0 - 9.0	01A140AHO090Z	18.0	18.0	19.5	32.6	0.6	18.0	13.0	7200	148	142	25.7
M16 x 2.00	0.0 - 3.2	01A160AHO032Z	21.0	21.0	22.5	28.0	0.6	21.0	8.2	10000	232	222	30.7
	0.0 - 5.7	01A160AHO057Z	21.0	21.0	22.5	30.5	0.6	21.0	10.7	10000	232	222	32.6
	2.0 - 8.2	01A160AHO082Z	21.0	21.0	22.5	32.9	0.6	21.0	13.2	10000	232	222	34.5
	6.0 - 11.0	01A160AHO110Z	21.0	21.0	22.5	35.7	0.6	21.0	16.0	10000	232	222	36.6

Écrou à sertir en aveugle correspondant à l'ancienne désignation H ... FO ... ACIER
Blind Rivet Nuts corresponding to old designation H ... FO ... STEEL

