

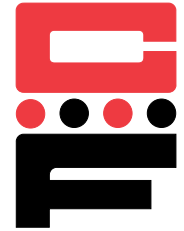

# Self-Clinching Nuts

## Series C & CS



C & CS nuts provide strong load-bearing threads in sheet metal and other thin section assemblies. Some C & CS nuts meet specification features of NASM45938/1.

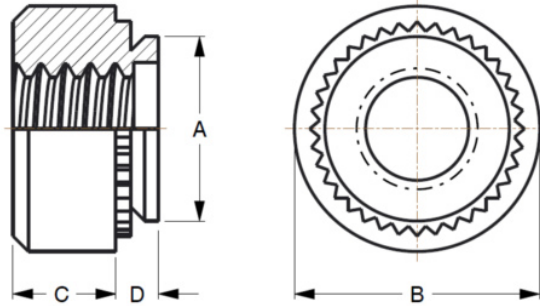

Series	Material	Finish
C	Heat-treated Carbon Steel	Zinc* Clear
CS	300 Series Stainless Steel	Passivated ASTM A967

\*See Finish Spec. on Page 6.

Thread: Internal 2B, ANSI B1.1 (6H, ANSI/ASME B1.13M).

Use In: C – Materials with HRB-80 or less.

CS – Materials with HRB-70 or less.

### Dimensions & Specifications

Thread Size	Part Number		D Max.	Min.	+.003 in. -.000	A Max.	B ±.01 in.	C ±.01 in.	Min.
	Carbon Steel	Stainless Steel							
#2-56	C256-0	CS256-0	.030	.030	.166	.165	.250	.070	.19
	C256-1	CS256-1	.038	.040					
	C256-2	CS256-2	.054	.056					
	C256-3	CS256-3	.087	.090					
#3-48	C348-0	CS348-0	.030	.030	.166	.165	.250	.070	.19
	C348-1	CS348-1	.038	.040					
	C348-2	CS348-2	.054	.056					
	C348-3	CS348-3	.087	.090					
#4-40	C440-0	CS440-0	.030	.030	.166	.165	.250	.070	.19
	C440-1	CS440-1	.038	.040					
	C440-2	CS440-2	.054	.056					
	C440-3	CS440-3	.087	.090					
#6-32	C632-0	CS632-0	.030	.030	.1875	.187	.280	.070	.22
	C632-1	CS632-1	.038	.040					
	C632-2	CS632-2	.054	.056					
	C632-3	CS632-3	.087	.090					
#8-32	C832-0	CS832-0	.030	.030	.213	.212	.310	.090	.27
	C832-1	CS832-1	.038	.040					
	C832-2	CS832-2	.054	.056					
	C832-3	CS832-3	.087	.090					

Continued on next page.

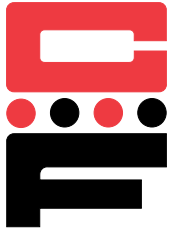

# Self-Clinching Nuts

## Series C & CS

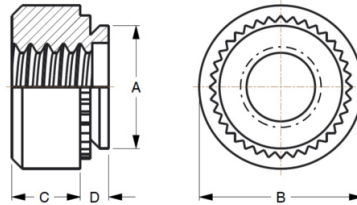
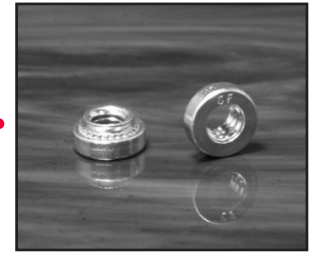

Continued from previous page.

### Dimensions & Specifications

Thread Size	Part Number		D Max.	Min.	+0.003 in. -.000	A Max.	B ±.01 in.	C ±.01 in.	Min.
	Carbon Steel	Stainless Steel							
#10-24	C1024-0	CS1024-0	.030	.030	.250	.249	.340	.090	.28
	C1024-1	CS1024-1	.038	.040					
	C1024-2	CS1024-2	.054	.056					
	C1024-3	CS1024-3	.087	.090					
#10-32	C1032-0	CS1032-0	.030	.030	.250	.249	.340	.090	.28
	C1032-1	CS1032-1	.038	.040					
	C1032-2	CS1032-2	.054	.056					
	C1032-3	CS1032-3	.087	.090					
#12-24	C1224-1	CS1224-1	.038	.040	.277	.276	.370	.130	.31
	C1224-2	CS1224-2	.054	.056					
	C1224-3	CS1224-3	.087	.090					
1/4-20	C420-0	CS420-0	.045	.047	.344	.343	.440	.170	.34
	C420-1	CS420-1	.054	.056					
	C420-2	CS420-2	.087	.090					
	C420-3	CS420-3	.120	.125					
1/4-28	C428-1	CS428-1	.054	.056	.344	.343	.440	.170	.34
	C428-2	CS428-2	.087	.090					
	C428-3	CS428-3	.120	.125					
5/16-18	C518-1	CS518-1	.054	.056	.413	.412	.500	.230	.38
	C518-2	CS518-2	.087	.090					
	C518-3	CS518-3	.120	.125					
5/16-24	C524-1	CS524-1	.054	.056	.413	.412	.500	.230	.38
	C524-2	CS524-2	.087	.090					
	C524-3	CS524-3	.120	.125					
3/8-16	C616-1	CS616-1	.087	.090	.500	.499	.560	.270	.44
	C616-2	CS616-2	.120	.125					
	C616-3	CS616-3	.235	.250					
3/8-24	C624-1	CS624-1	.087	.090	.500	.499	.560	.270	.44
	C624-2	CS624-2	.120	.125					
	C624-3	CS624-3	.235	.250					
1/2-13	C813-1	CS813-1	.120	.125	.656	.655	.810	.360	.63
	C813-2	CS813-2	.235	.250					

Continued on next page.



# Self-Clinching Nuts

## Series C & CS

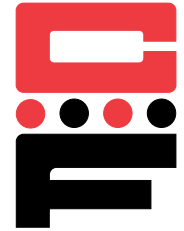

Continued from previous page.

### Dimensions & Specifications

Thread Size	Part Number		D Max.	Min.	+0.08 mm -0.00	A Max.	B ±.25 mm	C ±.25 mm	Min.
	Carbon Steel	Stainless Steel							
M2 x 0.4	CM2-0	CSM2-0	.77	.8	4.22	4.20	6.35	1.5	4.8
	CM2-1	CSM2-1	.97	1.0					
	CM2-2	CSM2-2	1.38	1.4					
	CM2-3	CSM2-3	2.21	2.29					
M2.5 x 0.45	CM2.5-0	CSM2.5-0	.77	.8	4.22	4.20	6.35	1.5	4.8
	CM2.5-1	CSM2.5-1	.97	1.0					
	CM2.5-2	CSM2.5-2	1.38	1.4					
	CM2.5-3	CSM2.5-3	2.21	2.29					
M3 x 0.5	CM3-0	CSM3-0	.77	.8	4.22	4.20	6.35	1.5	4.8
	CM3-1	CSM3-1	.97	1.0					
	CM3-2	CSM3-2	1.38	1.4					
	CM3-3	CSM3-3	2.21	2.29					
M3.5 x 0.6	CM3.5-0	CSM3.5-0	.77	.8	4.75	4.73	7.11	1.5	5.6
	CM3.5-1	CSM3.5-1	.97	1.0					
	CM3.5-2	CSM3.5-2	1.38	1.4					
	CM3.5-3	CSM3.5-3	2.21	2.29					
M4 x 0.7	CM4-0	CSM4-0	.77	.8	5.41	5.38	7.87	2.0	6.9
	CM4-1	CSM4-1	.97	1.0					
	CM4-2	CSM4-2	1.38	1.4					
	CM4-3	CSM4-3	2.21	2.29					
M5 x 0.8	CM5-0	CSM5-0	.77	.8	6.35	6.33	8.64	2.0	7.1
	CM5-1	CSM5-1	.97	1.0					
	CM5-2	CSM5-2	1.38	1.4					
	CM5-3	CSM5-3	2.21	2.29					
M6 x 1.0	CM6-0	CSM6-0	1.15	1.2	8.75	8.73	11.18	4.08	8.6
	CM6-1	CSM6-1	1.38	1.4					
	CM6-2	CSM6-2	2.21	2.29					
	CM6-3†	CSM6-3	3.05	3.18					
M8 x 1.25	CM8-1	CSM8-1	1.38	1.4	10.5	10.47	12.7	5.47	9.7
	CM8-2	CSM8-2	2.21	2.29					
	CM8-3†	CSM8-3	3.05	3.2					
M10 x 1.5	CM10-1	CSM10-1	2.21	2.29	14.0	13.97	17.35	7.48	13.5
	CM10-2	CSM10-2	3.05	3.18					
	CM10-3†	CSM10-3†	6.00	6.4					
M12 x 1.75	CM12-1†	CSM12-1†	3.05	3.18	17.0	16.95	20.57	8.5	16
	CM12-2†	CSM12-2†	6.00	6.4					

†Not stocked, available upon special order.

Continued on next page.



# Self-Clinching Nuts

## Series C & CS



Continued from previous page.

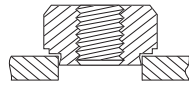

Fastener Must Be Installed  
Squarely In Hole

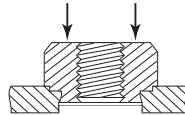

Squeezing Force Is Applied  
To Head Of Fastener

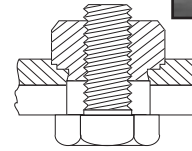

Install Bolt Or Screw  
From Opposite Side  
Of Head Of Fastener

### Installation & Performance Data

Thread Size	Shank Code	Cold-rolled Steel			5052-H34 Aluminum		
		Installation Force (lbs.)	Pushout (lbs.)	Torque-out (in.-lbs.)	Installation Force (lbs.)	Pushout (lbs.)	Torque-out (in.-lbs.)
#2-56 #3-48 #4-40	-0	2500-3500	105	13	1500-2000	63	8
	-1		125	15		90	10
	-2		230	18		170	13
	-3		230	18		170	13
#6-32	-0	3000-6000	110	16	2500-3000	63	16
	-1		130	20		95	17
	-2		275	28		190	22
	-3		275	28		190	22
#8-32	-0	4000-6000	110	26	2500-3000	68	21
	-1		145	35		105	23
	-2		285	45		220	35
	-3		285	45		220	35
#10-24 #10-32	-0	4000-9000	120	30	2500-3000	68	20
	-1		180	40		110	32
	-2		320	60		190	50
	-3		320	60		225	50
#12-24	-1	5000-6500	200	74	2500-6500	120	63
	-2		350	80		285	70
	-3		350	80		285	70
1/4-20 1/4-28	-0	6000-8000	315	115	4000-7000	220	70
	-1		400	150		360	90
	-2-3		400	150		360	125
5/16-18 5/16-24	-1	6000-8000	420	165	4000-7000	380	120
	-2-3		420	180		380	160
3/8-16 3/8-24	-1-2-3	7000-11000	460	320	5000-8000	400	270
	-1-2		10000-15000	1050		735	7000-9000

Continued on next page.



# Self-Clinching Nuts

## Series C & CS

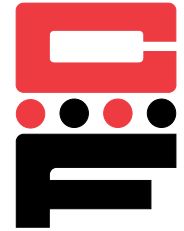

Continued from previous page.

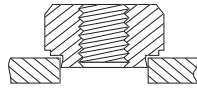

Fastener Must Be Installed  
Squarely In Hole

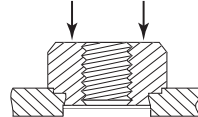

Squeezing Force Is Applied  
To Head Of Fastener

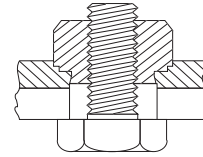

Install Bolt Or Screw  
From Opposite Side  
Of Head Of Fastener

### Installation & Performance Data

Thread Size	Shank Code	Cold-rolled Steel			5052-H34 Aluminum		
		Installation Force (kN)	Pushout (N)	Torque-out (N·m)	Installation Force (kN)	Pushout (N)	Torque-out (N·m)
M2 M2.5 M3	-0	11.2-15.6	470	1.47	6.7-8.9	280	.9
	-1		550	1.7		400	1.13
	-2		1010	2.03		750	1.47
	-3		1100	2.0		850	1.47
M3.5	-0	13.4-26.7	480	1.8	11.2-13.5	280	1.8
	-1		570	2.3		400	1.92
	-2		1210	2.3		840	2.5
	-3		1300	2.5		1050	2.8
M4	-0	18-27	490	2.95	11.2-13.4	300	2.37
	-1		645	4		470	2.6
	-2		1250	5.1		970	4.0
	-3		1300	4.2		1100	4.0
M5	-0	18-38	530	3.6	11.2-15.6	300	3.0
	-1		800	4.5		480	3.6
	-2		1420	6.8		845	5.7
	-3		1500	6.0		1225	5.7
M6	-0	27-36	1380	13	18-32	970	7.9
	-1-2-3		1760	17		1580	10.2 / 14.1
M8	-1-2-3	27-36	1870	18.7 / 20.3	18-32	1570	13.6 / 18.1
M10	-1-2-3	32-50	2020	36.2	22-36	1760	32.7
M12	-1-2	33-49	3065	73.9	23-30	1390	35.2